



Qlamp New Back-Lighting Panel Light

Q-MBD-6060-40WW

Q-MBD-6060-40NW

Q-MBD-6060-40CW

DESCRIPTION:

- Back-Lighting provides even light distribution.
- Higher efficiency up to 120Lm/W.
- Pure Aluminum Shell.
- TUV certified Moso Driver.
- 90% Energy Saving.
- Eco-friendly no Mercury.
- Dimmable Optional.
- Low Maintenance

Application:

LED ceiling light is a new generation of cold light source with high luminous efficiency, low power consumption, long life span, easily controlled, free maintenance, safety and friendly environment, remote lighting, good cast performance, wide working voltage range, the light source adopts microcomputer built-in controller, can realize ,soften color, gorgeous, varied and colorful, low loss, low energy consumption, environment friendly, suitable for shopping malls, banks, hospitals, hotels, restaurants and other public places for long time lighting.



DIMENSIONS (mm):

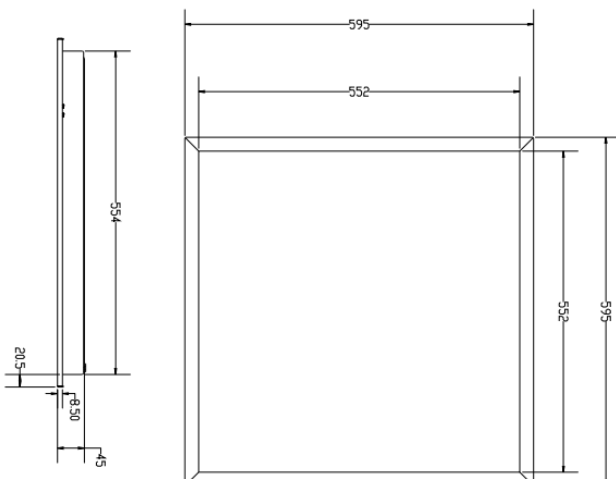

TECHNICAL SPECIFICATION

Model No.	Power	CCT	Lumen	Base	Voltage
Q-MBD-6060-40WW	40W	2800-3200K	4000lm	N/A	AC85-277V
Q-MBD-6060-40NW		3700-4200K	4200lm		
Q-MBD-6060-40CW		5700-6300K	4200lm		
Color Rendering Index		Ra >80			
Cover Optical		PC 92%			
Luminous Efficacy		120Lm/W			
Lighting source		528pcs Epistar SMD2835 Chip			
Power factor		0.95			
Driver efficacy		88%			
Beam angle		120°			
Net Weight		2.35kg			
Quality guarantee		5 years			
Dimmable		Optional			
Life span		>40,000hrs			
Working Temperature		-20°C~40°C			
IP Rating		IP44 (IP65 for option)			

DIMENSIONS (mm):

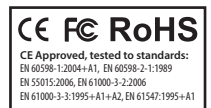
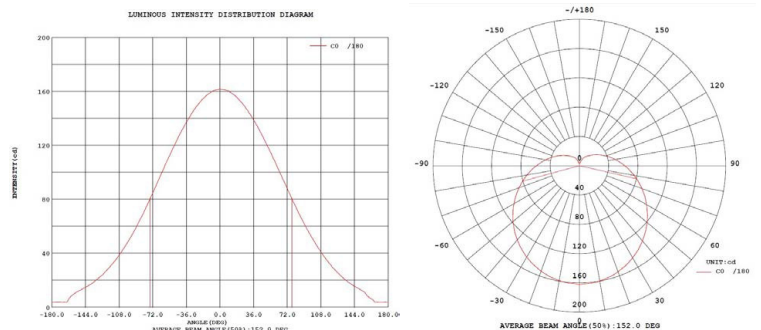

POWERSAVE SOLUTIONS LTD

HEAD OFFICE: Unit 7, The Sandon Estate, Sandon Way, Liverpool L5, 9YN

LONDON OFFICE: 129 Colney Hatch Lane, N10 1HD

e-mail: info@powersavesolutions.co.uk facebook.com/powersavesolutions www.powersavesolutions.co.uk